

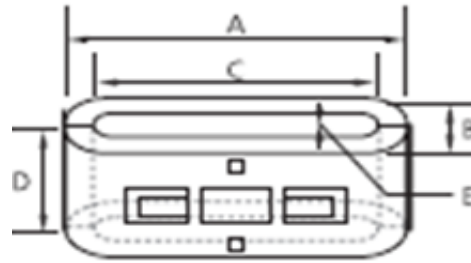

Ferrite Cores

HSCFS TYPE



| NO | Specifications | Dimensions:mm | | | | | Impedance(Ω) min | |
|----|--------------------------|---------------|---------------|------------|--------------|-------------|---------------------------|--------|
| | | A | B | C | D | E | 25MHz | 100MHz |
| 1 | HSCFS 33.5X6.8X28X12-1.8 | 36 \pm 1 | 9.4 \pm 0.8 | 28 \pm 1 | 14.8 \pm 1 | 2 \pm 0.4 | 30 | 100 |

The data is reference only. Customers should verify actual device performance in their specific applications. Specifications are subject to change without notice. Please check our website for latest information. <http://www.ftind.com>